

Narrow By [Clear All](#)

Type

 Round Body

Stroke Length

1"	7"	13"
2"	8"	14"
3"	9"	15"
4"	10"	16"
5"	11"	17"
6"	12"	18"

Force @ 100 psi, lbs.

1 to 24	100 to 249
25 to 49	250 to 499
50 to 99	

Bore Size

9/16"	1 1/2"
3/4"	1 3/4"
1 1/16"	2"
1 1/4"	2 1/2"

Switch

Switch Ready

94 Products

Switch-Ready Stainless Steel Air Cylinders

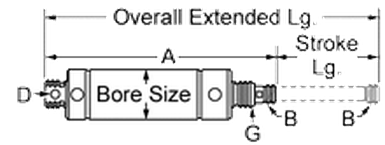
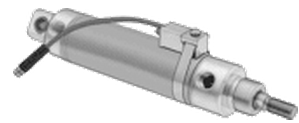

Shown with Switch
(Sold Separately)

Switch-ready cylinders make it a cinch to add an optional switch (sold separately below) to actuate relays, solenoids, controllers, and more. All of these cylinders are double acting—they have two compressed air ports: one to extend in the "push" direction and another to retract in the "pull" direction. They are nonrepairable, which means you simply replace them when necessary.

Cylinders have a Type 304 stainless steel barrel; Type 303 stainless steel rod; oil-impregnated, sintered-bronze rod bushing; and aluminum end caps. They can be nose or pivot mounted. Mounting nut not included. Maximum pressure is 250 psi. Temperature range is -20° to +200° F.

To Order: Please specify stroke length in 1" increments from the ranges listed.

For additional information and specifications view [More About Stainless Steel Air Cylinders](#).

Bore Size	Force @ 100 psi, lbs.	Port Pipe Size, Female	Retracted Lg. (A)	Rod, Thread Size x Lg. (B)	OD	Pin Dia. (D)	Mounting Thread (G)
9/16"	22	10-32 UNF	3.5" + Stroke Lg.	10-32 x 0.5"	0.62"	0.157"	7/16"-20

Narrow By Clear All

For Use With Show

✓ Air

Actuation Pressure

- Ultra Low (0-20 psi)
- Low (21-100 psi)
- Medium (101-1,000 psi)
- High (above 1,000 psi)

Environment

- Indoor Use (NEMA 1)
- Washdown Indoor/Outdoor Use (NEMA 4)
- Washdown/Corrosion Resistant (NEMA 4X)
- Hazardous Location (NEMA 7)
- Dust/Oil Resistant (NEMA 13)
- Not Rated

Pipe Size

- 1/8 3/8
- 1/4 1/2

Pipe Connection Material

- Brass
- Stainless Steel
- Steel
- Aluminum

91 Products

Nonadjustable Pressure Switches

approximately 15% below the actuation point.



Each 3454K1 \$48.08

Miniature Digital Pressure Switches

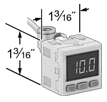

- Use with air, argon, and nitrogen
- Connection: Nickel-plated brass
- Amp Rating: 80 mA @ 28 volts DC

Small enough to fit in tight spaces, use these switches with your programmable logic controller (PLC) for process automation. Set the LCD to show your pressure, actuation point, or deactuation point. Digit height is 3/8". Accuracy is ±0.2%. Housing is PBT plastic (polybutylene terephthalate) and seal is nitrile. Temperature range is 32° to 122° F. Switches have wire leads. View information about NPN and PNP switches.

Optional panel-mount bracket fits a 1 7/32" x 1 7/32" cutout.

Actuation Range, psi	Deactuation Range, psi	Max. Signal	PLC Output	Each
With 1/8 NPT Male Connection				
0-145	1-145	215	NPN	3167K13 \$119.74
0-145	1-145	215	PNP	3167K14 119.74
With Push-to-Connect Fitting for 1/4" OD Tubing				
0-145	1-145	215	NPN	3167K15 119.74
0-145	1-145	215	PNP	3167K16 119.74
		Optional Panel-Mount Bracket	3167K91	Each \$4.09

Digital Pressure Switches



- Use with air, water, and hydraulic oil
- Pipe Connection: Type 316 Stainless Steel NPT Male
- Amp Rating: 10 amps @ 250 volts AC

Install a switch that provides pressure readings at the source of your application. Set the LED to show your pressure, actuation point, or deactuation point. Digit height is 1/2". Accuracy is ±0.3%. Switches are single pole, double throw (SPDT)—they switch one circuit.

Housing is epoxy-coated aluminum and seal is Type 17-4 PH stainless steel. Temperature range is -20° to 180° F. Enclosure is NEMA 4X (washdown/corrosion resistant). Switches have screw terminals and a 3/4 NPT female conduit port.

Actuation Range, psi	Deactuation Range, psi	Max. psi	Pipe Size	Each
3-60	0.03-57	120	1/4	7564T11 \$672.72
5-100	0.05-95	200	1/4	7564T12 672.72
10-200	0.1-190	400	1/4	7564T13 672.72
150-3,000	1.5-2,850	4,500	1/4	7564T19 672.72

Pressure Switches



- Use with air, water, hydraulic oil, and diesel fuel
- Pipe Connection: Brass NPT male
- Amp Rating: 10 amps @ 125/250 volts AC

